

Pressure gauges AISI 316 with glycerin
 Pressure gauge DN 100 with glycerin

Pressure gauge DN 100 vertical connection

DICSA

1/1

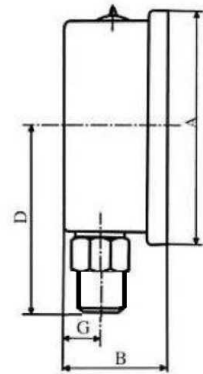
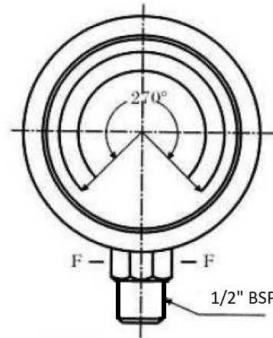

Accuracy: 1,6%

Dimensions: A=109
 B=35,5
 D=74
 F=HEX 14
 G=11,5

Temperature: from -10 up to +60

Fitting and internal components: Stainless steel 316L

Case: Stainless steel 304

| Part n° | R2 | Scale (bar) |
|---------------|----------|-------------|
| ZMFI10008006V | 1/2" BSP | 0-6 |
| ZMFI10008010V | 1/2" BSP | 0-10 |
| ZMFI10008016V | 1/2" BSP | 0-16 |
| ZMFI10008025V | 1/2" BSP | 0-25 |
| ZMFI10008040V | 1/2" BSP | 0-40 |
| ZMFI10008060V | 1/2" BSP | 0-60 |
| ZMFI10008100V | 1/2" BSP | 0-100 |
| ZMFI10008160V | 1/2" BSP | 0-160 |
| ZMFI10008250V | 1/2" BSP | 0-250 |
| ZMFI10008400V | 1/2" BSP | 0-400 |
| ZMFI10008600V | 1/2" BSP | 0-600 |

With dual bar/psi scale